

Property Map
Town of Searsmont
 Waldo County, Maine
 April 1, 2024

- Legend**
- Parcel Boundary
 - Public ROW
 - - - Private ROW
 - - - Utility ROW
 - - - Discontinued ROW
 - Townline
 - Streams
 - Lakes, Ponds, Rivers
 - Adjacent Maps

DISCLAIMER: This map is intended for property tax assessment purposes only. The information contained on this map is based upon recorded deeds, plans, and other public sources. These primary sources should be consulted to verify the information contained on this map. Due to conflicts, errors, and omissions in the primary sources, the tax map should be considered to be a representation of the editor's judgment, based upon the available evidence. Tax maps are not legal evidence of size, shape, location, or ownership of real estate, roads, or municipal boundaries.

THE TOWN OF SEARSMONT ASSUMES NO LIABILITY RELATED TO THE USE OF THIS MAP. THIS MAP IS NOT A SURVEY.

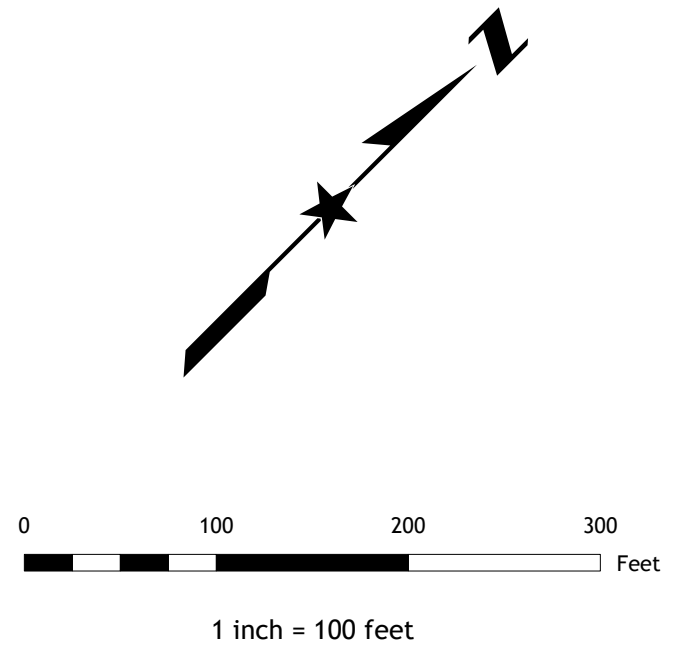

Northern Geomatics, Inc.
 PO Box 557, Bradford, NH 03221
 bluffy@northgco.com
 www.northgco.com

MAP 12A

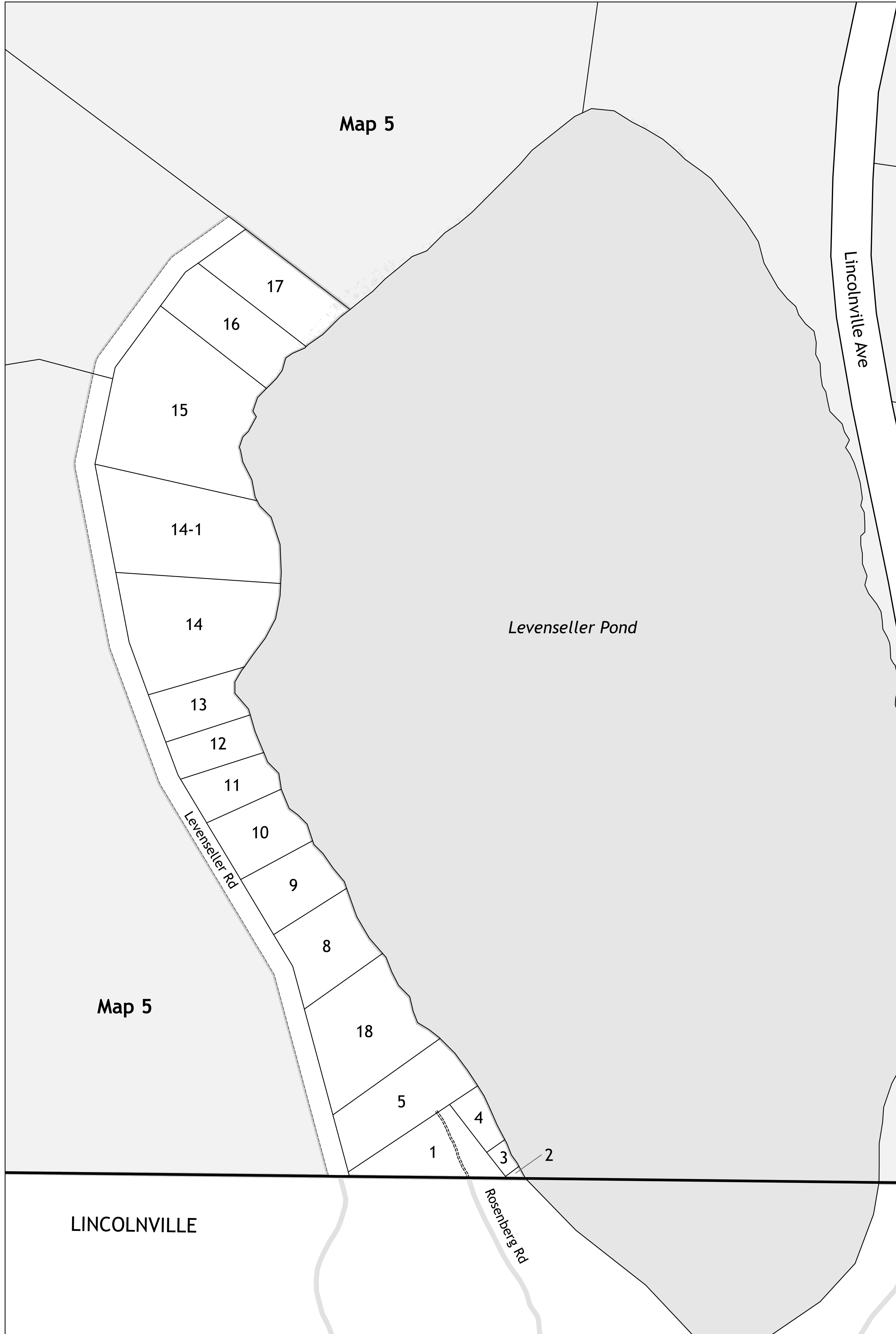

MAP 12A

MAP 12B

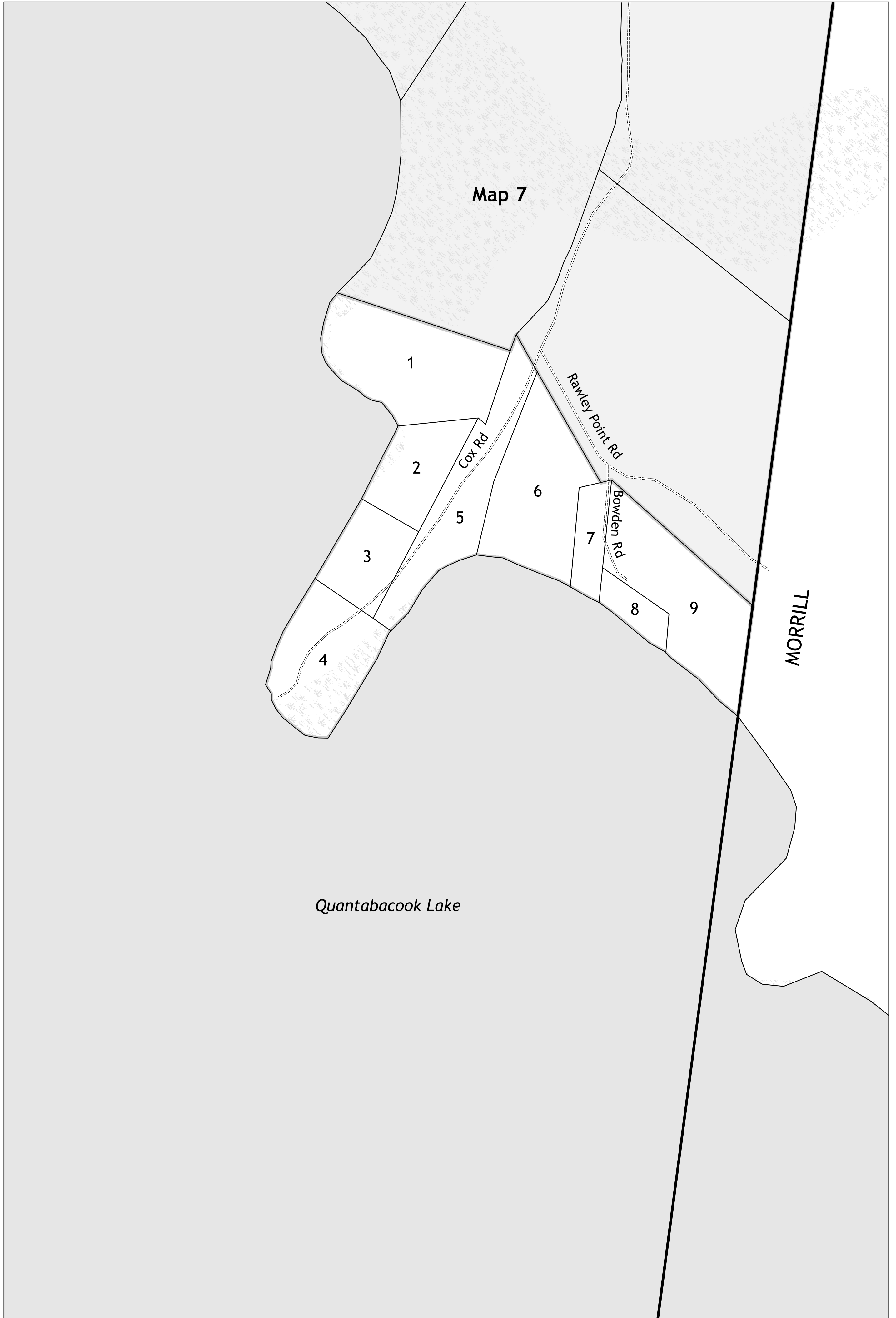

MAP 12B